

CombiLine

Magazine shelf Expo

Design | TreCe

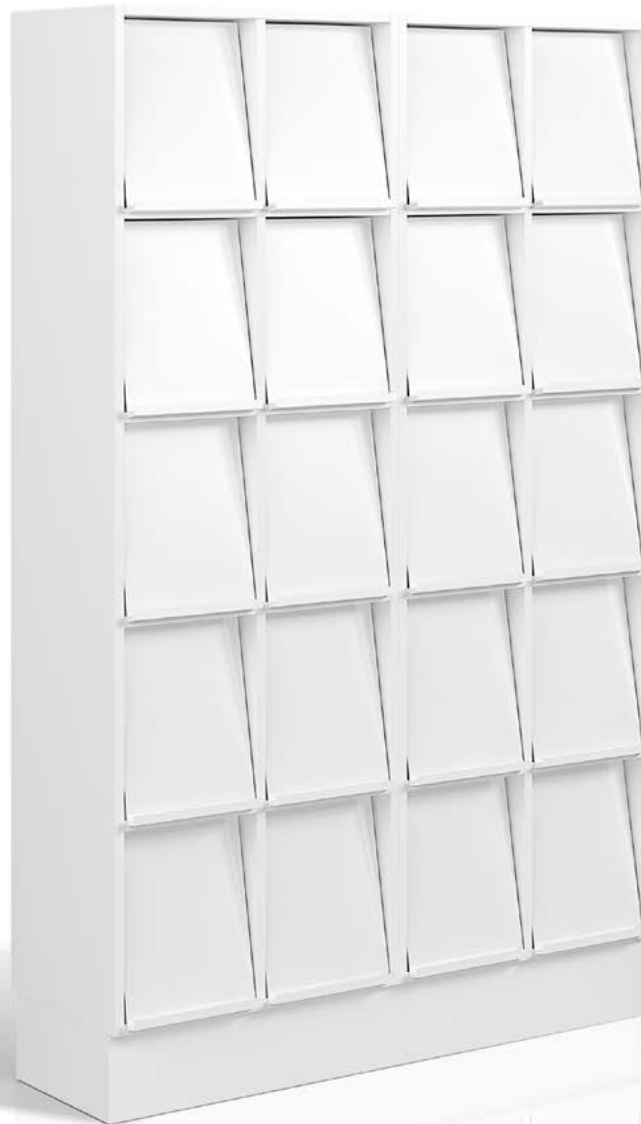

Display area in black or white powder-coated steel for showing newspapers, books or reference materials.

Plenty of storage space behind the display areas.
Mounting strip is included with all wall modules.

Our standard widths are 310 mm, 605 mm and 900 mm.

CombiLine Magazine shelf Expo

Frame: 19 mm.

Plinth height: 157 mm.

Mounting strip is included in all wall-mounted products.
NCS refers to product lacquered in one optional NCS color.

V = White shelves
S = Black shelves

CombiLine Magazine shelf Expo, Wall

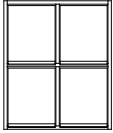

EXPO 60/4
605x723x370



EXPO 90/6
900x723x370

Height 723 mm, Depth 370 mm

Name	White	NCS	Beech	Birch	Oak
EXPO 60/4V	841332V	849332VL	843332V	845332V	847332V
EXPO 60/4S	841332S	849332SL	843332S	845332S	847332S
EXPO 90/6V	841333V	849333VL	843333V	845333V	847333V
EXPO 90/6S	841333S	849333SL	843333S	845333S	847333S



EXPO 60/6
605x1075x370

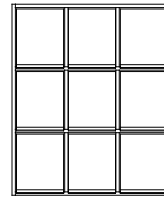

EXPO 90/9
900x1075x370

Height 1075 mm, Depth 370 mm

Name	White	NCS	Beech	Birch	Oak
EXPO 60/6V	841342V	849342VL	843342V	845342V	847342V
EXPO 60/6S	841342S	849342SL	843342S	845342S	847342S
EXPO 90/9V	841343V	849343VL	843343V	845343V	847343V
EXPO 90/9S	841343S	849343SL	843343S	845343S	847343S

CombiLine Magazine shelf Expo, Floor

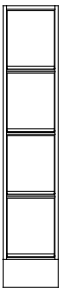

EXPO 30/4
310x1584x370

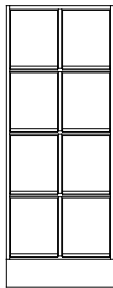

EXPO 60/8
605x1584x370

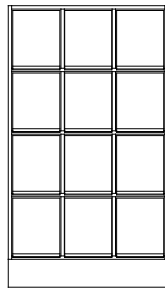

EXPO 90/12
900x1584x370

Height 1584 mm, Depth 370 mm

Name	White	NCS	Beech	Birch	Oak
EXPO 30/4V	841321V	849321VL	843321V	845321V	847321V
EXPO 30/4S	841321S	849321SL	843321S	845321S	847321S
EXPO 60/8V	841322V	849322VL	843322V	845322V	847322V
EXPO 60/8S	841322S	849322SL	843322S	845322S	847322S
EXPO 90/12V	841323V	849323VL	843323V	845323V	847323V
EXPO 90/12S	841323S	849323SL	843323S	845323S	847323S



EXPO 30/5
310x1936x370



EXPO 60/10
605x1936x370

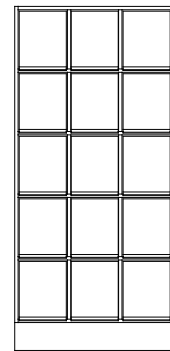

EXPO 90/15
900x1936x370

Height 1936 mm, Depth 370 mm

Name	White	NCS	Beech	Birch	Oak
EXPO 30/5V	841311V	849311VL	843311V	845311V	847311V
EXPO 30/5S	841311S	849311SL	843311S	845311S	847311S
EXPO 60/10V	841312V	849312VL	843312V	845312V	847312V
EXPO 60/10S	841312S	849312SL	843312S	845312S	847312S
EXPO 90/15V	841313V	849313VL	843313V	845313V	847313V
EXPO 90/15S	841313S	849313SL	843313S	845313S	847313S

CombiLine

MFC laminated and lacquered surfaces within CombiLine have a chip core, with the exception of some shelves. Back, frame, doors and edge strips have the same color/wood as other parts as standard, unless otherwise stated.

Frame

Thickness 19 mm, 0.8 mm straight ABS-lipping.

- MFC laminate white, beech, birch and oak.
- Lacquered available in any NCS-color.

Back

Thickness 12 mm, laminate inside and outside.

Plinth

Every module has its own front and back plinth with 4 adjustable feet (does not apply to recycling units with loading ramps).

Plinth height 157 mm. Can be replaced with;

- Bottom plate with adjustable stainless steel legs, height 157 mm.
- Bottom plate with lockable wheels, height 104 mm.

Doors

Thickness 16 mm, 2 mm straight ABS-lipping.

- White lacquered UV-treated MFC laminate (NCS S 0500-N), or MFC laminate in beech/birch/oak.
- Lacquered in any NCS color.
- Self closing concealed hinges with integrated soft closing (does not apply to products with aximat hinges with 180° opening).
- Single doors are right-hung as standard.

Drawer fronts

Thickness 16 mm, 2 mm straight ABS-lipping.

- White lacquered UV treated MFC laminate (NCS 0500-N) and MFC laminate in beech/birch/ oak.
- Lacquered available in any NCS-color.

Drawers

Drawers with depth 570 mm have soft closing.

- Extension 70%, max 30 kg.
- Extension 100%, max 35 kg (excl. recycling units).
- Extension 100%, max 50 kg.

Shelves

All shelves are adjustable and mounted with milled-in shelf support.

Drill division c/c 32 mm.

- 310 – 605 mm have a chip core.
- 800 – 900 mm have a pine lamellar core.

Recycling unit

MDL60/MD60/MDH60/MD65/MD70

The bottom plate is equipped with an access ramp in stainless steel.

- Doors with aximat hinges for 180 degree opening for easy access to recycling containers.

Mail shelves

Adjustable with pull-out function and mounting strip, subdivision c/c 96 mm.

- Mail shelves in acrylic have integrated name slots.
- Mail shelves in powder coated steel white or black are available as an addition.

Steel doors mail sorting

White powder coated steel. Shelves inside in the same material as frame, 19 mm.

- Including lock and 2 keys with individual lock number.
- Inlet 22 mm. Open door gives a free space of 90 mm.

Wall modules

White lacquered mounting strip in steel is included for all wall modules.

Lock types

Cabinets locks, padlock fittings, code locks and RFID-locks (EM & Mifare).

Fitting pieces /Cover panels

Available as accessories in the same color/material as frame. Width, height and depth adapted to your requirements.

Handles

Stainless steel bow handles as standard, if you would like black or white handles, please not on order.

- Standard handles c/c 128 mm.
- Grip handles 40 mm.

General info

Mounting

All modules are factory mounted Worktops/Cover panels/Top covers are mounted on site.

Warranty

We provide a 5 year factory warranty on CombiLine. Other products, contact TreCe.

Cabinet locks

Robust cabinet locks with master key system, individual nr. with 2 keys as standard. Identical locks available to addition.

Contact TreCe for customization of selected product.

Sustainability

CombiLine



Quick info.

Content	Certification TreCe	Certification TreCe
Environment, quality & social aspects	ISO 9001:2015	ISO 14001:2015
Country of manufacture	Certification product	Approved user environments
Sweden	Möbelfakta	Offices, public spaces & schools

Wood

Particle boards in white, beech, birch and oak meets the requirements regarding wood, see Table 1. No wood-based materials are used that origin from forest environments with high biological or social values. TreCe has ensured traceability of wood-based materials, and that the materials origins from documented and legal forestries.

Table 1: Requirements wood

Requirements	Complies
The wood in the product is traceable and come from legal forestries.	X
The wood complies with the requirements for formaldehyde emission requirements according to E1.	X

Metal

Fittings such as hinges, screws and handles for-fill the requirements in Table 2.

Table 2: Requirements metal

Requirements	Complies
Surface treatment must not contain lead or cadmium	X
Aromatic hydrocarbons are not actively added and should not be included in preparations / formulations according to REACH Appendix XVII and KIFS 2005:7.	X
Furniture/products should not be surface treated with products/formulations that are labeled as dangerous according to KIFS 2005:7, CLP 1272/2008 or Regulation 790/2009.	X
The product must not have active addition of or have passivation of metal surfaces with chromium VI. The exception are small fitting corresponding to <5% by weight, for example hinges or fittings.	X

Plastic

Plastic parts such as edgings, fittings and post shelves meet the requirements in Table 3. For example, the post shelf is marked according to ISO 11469 with a stamp. The stamp shows the type of plastic and thus makes it possible to recycle and reuse the material.

Table 3: Requirements plastic

Requirements	Complies
Plastic parts >50 grams are permanently marked according to ISO 11469	X
Free from PVC (polyvinyl chloride)	X
Free from plasticizers containing phthalates -DEHP Di (2-ethylhexyl) phthalate -DBP (dibutyl phthalate) -BBP (benzyl butyl phthalate)	X
The following flame retardants have not been actively added or their maximum content amounts to 0.1% by weight measured value.	X
Polybrominated biphenyls (PBBs)	CAS-nr: 59536-65-1
Decabromodiphenyl ether (dekaBDE)	CAS-nr: 1163-19-5
Pentabromodiphenylether (pentaBDE)	CAS-nr: 32534-81-9
Oktabromodiphenylether (oktaBDE)	CAS-nr: 32536-52-0
Tris (2,3-dibromopropyl) phosphate (TBPP)	CAS-nr: 126-72-7
Tris (1-aziridinyl) phosphine oxide (TEPA)	CAS-nr: 5455-55-1
Hexabromocyclododecane (HBCDD)	CAS-nr: 25637-99-4
Tris (2 chlorethyl) phosphate (TCEP)	CAS-nr: 115-96-8
No pigments containing lead, cadmium, tin, chromium VI or mercury have not been actively added or their content is max. 0.01% by weight measured value per part.	X



Adhesives

Adhesives that are used contain less than 10% VOC (vapor pressure > 0,01kPa*) and less than 0.2% free formaldehyde, see Table 4.

Table 4: Requirements adhesives

Requirements	Complies
Adhesives used in the manufacture of furniture or components for furniture may contain a maximum of 10% by weight VOC.	X
Adhesives used in the manufacture of furniture or components for furniture may contain a maximum of 0.2% by weight of free formaldehyde.	X

Surface treatment - white

Doors and fronts are UV-lacquered in white and meet the requirements stated in Tables 5 and 6. Safety data sheets are sent on request. Direct laminate products in beech, birch and oak are not surface treated.

Table 5: Requirements surface treatment

Requirements	Complies
The content of aromatic solvents / hydrocarbons in surface treatment products / preparations may not exceed 1.0% by weight.	X
Surface treatment with preparations containing VOC may have a maximum applied VOC component of 60 g / m ² for office / public / outdoor environment.	X

Table 6: Hazard class and hazard statement according to Regulation 790/2009.

Hazard category	Hazard statement according to regulation 790/2009	Complies
Acute toxicity	H300, H301, H310, H311, H330, H331	X
Toxic to body organs	H370, H371, H372, H373	X
Carcinogenic	H350, H351	X
Mutagenic	H340, H341	X
Toxic for reproduction	H360, H361	X
Allergenic	H334	X
Dangerous to the environment	H400, H410, H411, H412, H413 If the use of surface treatment products is required for technical reasons, products labelled as dangerous to the environment (H400, H410, H411, H412, H413) may be acceptable if the content of environmentally hazardous substance <14 g/per m ² of surface.	X

The production

CombiLine is manufactured and assembled in Sweden. Environmental aspects related to production are presented in Table 7.

Table 7: The environmental aspects of production.

Environmental aspect

Environmentally classified materials / chemicals	Particularly hazardous chemicals, phasing out substances or priority risk reduction substances are not used. Handling and storage of all chemicals and substances are regulated so emissions to air, ground or water do not occur.
Surface coating	During the surface coating the production works actively to minimize the environmental impact through special handling and environmentally adapted colors and solvents. For example excess paint is collected and reused.
Emissions air	Emissions below the set license conditions. An air filter cleaner is installed that recycles tempered air which saves energy and reduces emissions to the outdoor environment.
Emissions water	Emissions below the set license conditions. Substances that are discharged into wastewater are environmentally friendly and contain no chemicals that the treatment plants cannot handle. Adhesives and varnishes that according to the safety data sheet are considered to pose a risk when released into water are collected in sealed containers and classified and treated as dangerous waste.
Waste	Residual material from particleboard is baled and collected for combustion in order to extract energy. TreCe is connected to the Packaging and Newspaper Collection (FTI). Waste is sorted according to the regulations that are based on the FTI and current legislation. Waste and residual products such as glue and oil residues are handled and collected separately.
Energy	In order to minimize energy consumption, heating is regulated based on working hours and which workstations are staffed. Investment in a compressor for a sustainable use of electricity resulted in an energy reduction of about 110,000 kWh/year.
Production optimization	The production process is optimized to save on materials, resulting in a reduced amount of waste, and to minimize energy consumption.
Energy per product	The energy consumption in electricity per product is 8.8 kWh.

The product

Environmental aspects linked to the product in addition to the materials are presented in Table 8.

Table 8: The products aspects.

Aspect

Packaging	Stretch film and corrugated board used to pack TreCe products are free of chlorine and bleach. The box is glued with wheat or cornstarch.
Reuse and restoration	One of our core values is Smart design. This means, among other things, that we look at design from a wider perspective. TreCe products are long lasting. Instead of replacing the whole piece of furniture, there is the option of replacing only a few parts. In this way, our products become sustainable in the long term - a benefit for both you as a user and for the environment.
Lifetime and warranty	TreCe provides a 5-year warranty on the entire range and spare parts are available for 10 years. The estimated usage life is from 5 years up to 30 years, depending on the area of use.
Recycling	Material recycling leads to a reduction in virgin material extraction and thus reduces carbon dioxide emissions. Hinges and fittings can be melted down and wood-based materials can be recycled for the production of new chipboard which is almost as high quality as virgin. The materials are submitted to recycling facilities, contact your municipality for more information. CombiLine is designed so that the different materials can be separated without special tools. When dismantling, no environmentally hazardous emissions occur.

Social responsibility

We have ensured that this product is manufactured under good conditions, ie. with regard to social and ethical issues such as working conditions, human rights, labor, environment and corruption. We have sent these requirements to our suppliers and subcontractors, who have each certified that they are followed. A summary is shown in Table 9 and applies to the entire manufacture process of a product and it's components.

The minimum requirement for all suppliers is the UN guidelines on the "Code of Conduct" and Möbelfaktas' requirements for Social responsibility, which are formulated from the UN Global Compact with principles based on below;

- UN Universal Declaration of Human Rights.
- Rio Declaration on Environment and Development.
- International Labor Organization (ILO) eight core conventions on human and labor rights.
- UN Convention against Corruption.
- Work environment requirements based on ILO conventions on health and safety

Table 9: Requirements for social responsibility.

Requirements		Complies
Legislation	The furniture and its components must be manufactured in accordance with national legislation.	X
Human Rights	Producers, manufacturers and suppliers operations must comply with human rights.	X
Working conditions	Wages, child labor, conditions of employment, working hours, benefits, penalties, freedom of association, forced labor and discrimination.	X
Working environment	The company must constantly strive to improve the working environment and workplace safety for its employees.	X
Environment	Identify environmental impact, work actively with environmental issues and involve staff. Procedures for law compliance must be in place and followed up.	X
Anti-corruption	No form of extortion, corruption, bribery or favoritism to or from employees or organizations is tolerated.	X

Quality

This product has undergone extensive quality tests for safety and function, as well as surface resistance. The criteria and standards apply to the public environment, school environment and office environment and are shown in Tables 10 and 11. The tests were conducted by RISE, a Swedish government research institute that performs testing and certification.

Table 10: Approved user environments.

Product	Approved user environments.	Complies
CombiLine-products with Möbelfakta label	Public environment	X
	School environment	X
	Office Environment	X

Table 11: Standards against which the product has been tested and approved.

Standard	Scope	Complies
SS-EN 14073-2:2004	Office furniture - Storage furniture - Part 2: Safety requirements	X
SS-EN 16121:2013 + A1:2018	Non-domestic storage furniture - Requirements for safety, strength, durability and stability	X
SS-EN 12720:2009 + A1:2013 SS 839117	Surface resistance Public environment / office Requirements Category 1	X