

# CombiLine Wall cabinet/shelf

Design | TreCe

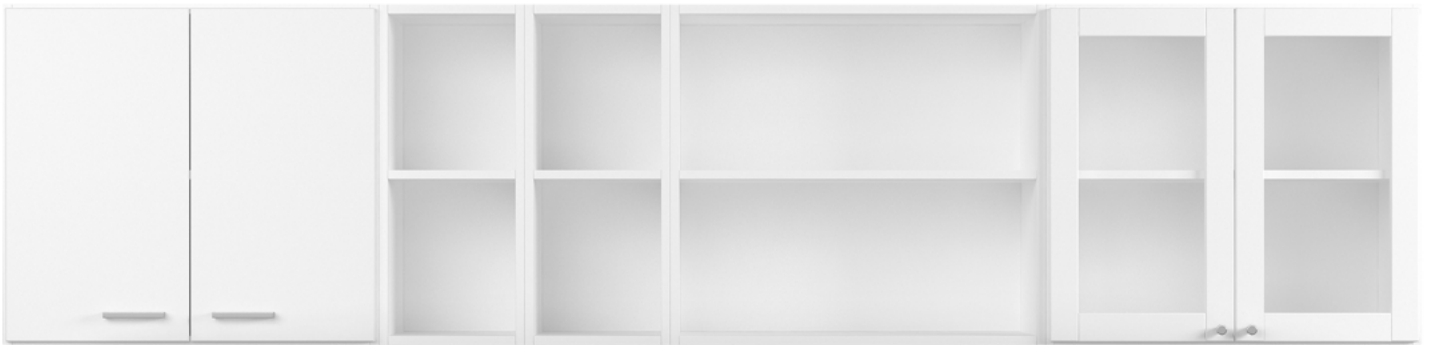

Wall mounted shelves and cabinets serve as space saving alternatives or complements to our floor standing modules.

Open modules are easily supplemented with doors, dividers or mail shelves. Available in standard white

or lacquered in any NCS colour. Mounting strip included all wall modules. Mounting strip included all wall modules. Standard heights: 371 mm, 723 mm and 1075 mm. Note! Write on your order if the handles are to be placed at the bottom or top of the cabinets.

**Dimensions:** Width x Height x Depth. **Frame:** 19 mm. **Front:** 16 mm.  
 Mounting strip is included in all wall mounted products.  
 NCS refers to product lacquered in one optional NCS colour.

**CombiLine Wall shelving/cupboards**



**VH30/1**  
310x371x370

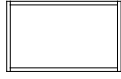

**VH60/1**  
605x371x370

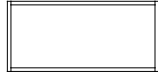

**VH80/1**  
800x371x370

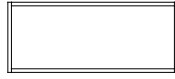

**VH90/1**  
900x371x370



**VS30/1**  
310x371x370

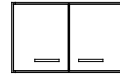

**VS60/1**  
605x371x370

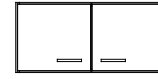

**VS80/1**  
800x371x370

Height 371 mm, Depth 370 mm

Name	White	NCS	Beech	Birch	Oak	Name	White	NCS	Beech	Birch	Oak
VH30/1	831322	839322L	833322	835322	837322	VS30/1	831422	839422L	833422	835422	837422
VH60/1	831313	839313L	833313	835313	837313	VS60/1	831413	839413L	833413	835413	837413
VH80/1	831331	839331L	833331	835331	837331	VS80/1	831433	839433L	833433	835433	837433
VH90/1	831314	839314L	833314	835314	837314						

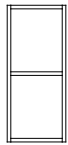

**VH30/2**  
310x723x370

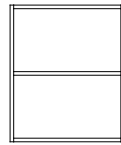

**VH60/2**  
605x723x370

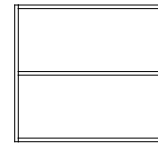

**VH80/2**  
800x723x370

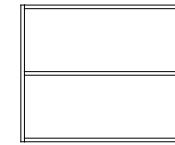

**VH90/2**  
900x723x370



**VS30/2**  
310x723x370



**VS60/2**  
605x723x370

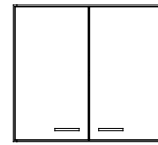

**VS80/2**  
800x723x370

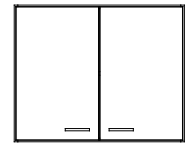

**VS90/2**  
900x723x370

Height 723 mm, Depth 370 mm

Name	White	NCS	Beech	Birch	Oak	Name	White	NCS	Beech	Birch	Oak
VH30/2	831321	839321L	833321	835321	837321	VS30/2	831421	839421L	833421	835421	837421
VH60/2	831311	839311L	833311	835311	837311	VS60/2	831411	839411L	833411	835411	837411
VH80/2	831332	839332L	833332	835332	837332	VS80/2	831432	839432L	833432	835432	837432
VH90/2	831312	839312L	833312	835312	837312	VS90/2	831412	839412L	833412	835412	837412



**Dimensions:** Width x Height x Depth. **Frame:** 19 mm. **Front:** 16 mm.  
 Mounting strip is included in all wall mounted products.  
 NCS refers to product lacquered in one optional NCS colour.

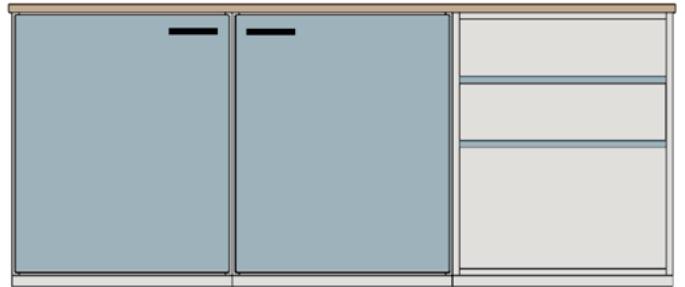
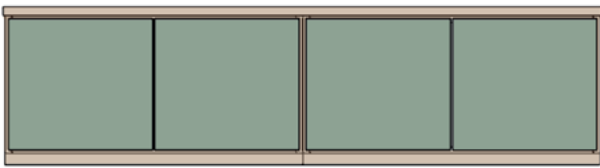

**CombiLine Wall shelving/cupboards**

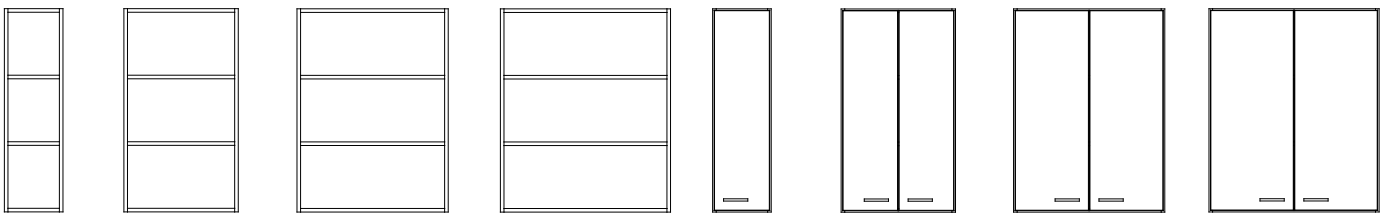

**VH30/3** 310x1075x370    **VH60/3** 605x1075x370    **VH80/3** 800x1075x370    **VH90/3** 900x1075x370    **VS30/3** 310x1075x370    **VS60/3** 605x1075x370    **VS80/3** 800x1075x370    **VS90/3** 900x1075x370

Height 1075 mm, Depth 370 mm

Name	White	NCS	Beech	Birch	Oak	Name	White	NCS	Beech	Birch	Oak
VH30/3	831323	839323L	833323	835323	837323	VS30/3	831423	839423L	833423	835423	837423
VH60/3	831315	839315L	833315	835315	837315	VS60/3	831415	839415L	833415	835415	837415
VH80/3	831333	839333L	833333	835333	837333	VS80/3	831434	839434L	833434	835434	837434
VH90/3	831316	839316L	833316	835316	837316	VS90/3	831417	839417L	833417	835417	837417

**Dimensions:** Width x Height x Depth. **Frame:** 19 mm. **Front:** 16 mm.  
Mounting strip is included in all wall mounted products.  
NCS refers to product lacquered in one optional NCS colour.

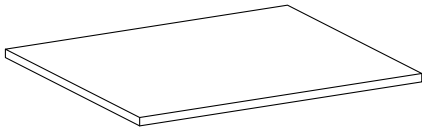

## Shelves, Depth 370 mm (Width x Depth)

Name	White	NCS	Beech	Birch	Oak
30/370	841916	849916L	843916	845916	847916
60/370	831921	839921L	833921	835921	837921
80/370	831923	839923L	833923	835923	837923
90/370	831922	839922L	833922	835922	837922

## Shelves, Depth 570 mm (Width x Depth)

Name	White	NCS	Beech	Birch	Oak
30/570	821913	829913L	823913	825913	827913
60/570	821914	829914L	823914	825914	827914
80/570	821916	829916L	823916	825916	827916
90/570	821915	829915L	823915	825915	827915

## Tempered Glass shelf, Depth 370 mm, 6 mm (Width x Depth)

Name	Art no.
60/370	840941
80/370	840942
90/370	840943

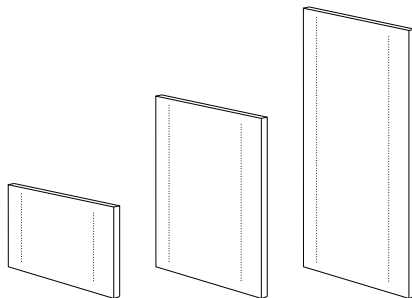

## Partition panel, fits width 605, 800 and 900 mm

Name	White	NCS	Beech	Birch	Oak
Partition panel 371	811913	819913L	813913	815913	817913
Partition panel 723	801912	809912L	803912	805912	807912
Partition panel 1075	801915	809915L	803915	805915	807915

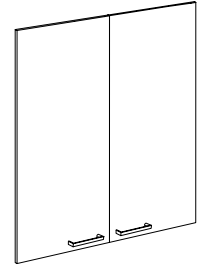

## Wooden doors Width/number of shelves

Name	White	NCS	Beech	Birch	Oak
30/1 (one)	841918	849918L	843918	845918	841918
30/2 (one)	831972	839972L	833972	835972	837972
30/3 (one)	831973	839973L	833973	835973	837973
30/4 (one)	831974	839974L	833974	835974	837974
30/5 (one)	831975	839975L	833975	835975	837975
60/1 (pair)	831940	839940L	833940	835940	837940
60/2 (pair)	831941	839941L	833941	835941	837941
60/3 (pair)	831942	839942L	833942	835942	837942
60/4 (pair)	831947	839947L	833947	835947	837947
60/5 (pair)	831943	839943L	833943	835943	837943
80/1 (pair)	831983	839983L	833983	835983	837983
80/2 (pair)	831949	839949L	833949	835949	837949
80/3 (pair)	831987	839987L	833987	835987	837987
80/4 (pair)	831992	839992L	833992	835992	837992
80/5 (pair)	831993	839993L	833993	835993	837993
90/2 (pair)	831944	839944L	833944	835944	837944
90/3 (pair)	831945	839945L	833945	835945	837945

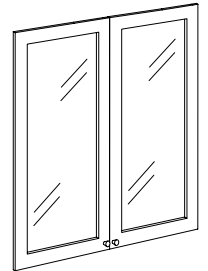

## Glass doors Width/number of shelves

Name	White	NCS	Beech	Birch	Oak
30/2 (one)	831957	839957L	833957	835957	837957
60/2 (pair)	831951	839951L	833951	835951	837951
60/3 (pair)	831952	839952L	833952	835952	837952
60/4 (pair)	831958	839958L	833958	835958	837958
60/5 (pair)	831953	839953L	833953	835953	837953
80/2 (pair)	831960	839960L	833960	835960	837960
80/3 (pair)	831995	839995L	833995	835995	837995
80/4 (pair)	831996	839996L	833996	835996	837996
80/5 (pair)	831997	839997L	833997	835997	837997
90/2 (pair)	831954	839954L	833954	835954	837954

If you would like tempered glass, contact TreCe

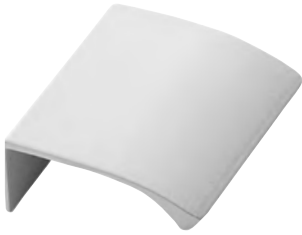

Grip handles Edge, addition



Handles, standard

### Grip handles Edge

Name	Size	Material	Art no.
Grip handles Edge*	40 mm	Stainless steel look	850322
Grip handles Edge*	40 mm	Black, brushed	850320
Grip handles Edge*	40 mm	White, laquered	850321

### Handles, standard

Name	Size	Stainless steel look	Black	White
Handles*	c/c 128 mm	850304	850302	850303

\* Stainless steel handles as standard, if you would like black or white please specify when ordering. If you would like other handles please contact TreCe.



### Knobs, standard

Name	Size	Stainless steel look	Black	White
Knob*	ø 19 mm	850313	850312	850314

\* Stainless knobs as standard, if you would like black or white please specify when ordering. If you would like other handles please contact TreCe.

### Cabinet locks (incl. 2 keys)

Name	Art no.
Cabinet locks, different lock numbers	830910
Addition, identical locks	830985

### Master key

Name	Lock type	Art no.
Master key	Cabinet locks	840913

# Specifications CombiLine

## CombiLine

MFC laminated and lacquered surfaces within CombiLine have a chip core, with the exception of some shelves. Back, frame, doors and edge strips have the same colour/wood as other parts as standard, unless otherwise stated.

## Frame

Thickness 19 mm, 0.8 mm straight ABS-lipping.

- MFC laminate white, beech, birch and oak.
- Lacquered available in any NCS-colour.

## Back

Thickness 12 mm, laminate inside and outside.

## Plinth

Every module has its own front and back plinth with 4 adjustable feet (does not apply to recycling units with loading ramps). Plinth 157 mm. Can be replaced with;

- Bottom plate with adjustable stainless steel legs, height 157 mm.
- Bottom plate with lockable wheels, height 104 mm.

## Doors

Thickness 16 mm, 2 mm straight ABS-lipping.

- White lacquered UV-treated MFC laminate (NCS S 0500-N), or MFC laminate in beech/birch/oak.
- Lacquered in any NCS colour.
- Self closing concealed hinges with integrated soft closing (does not apply to products with aximat hinges with 180° opening).
- Single doors are right-hung as standard.

## Drawer fronts

Drawer front, low: 173 mm

Drawer front, high: 349 mm

Thickness 16 mm, 2 mm straight ABS-lipping.

- White lacquered UV treated MFC laminate (NCS 0500-N) and MFC laminate in beech/birch/ oak.
- Lacquered available in any NCS-colour.

## Drawers

Drawers with depth 570 mm have soft closing.

- Extension 70%, max 30 kg.
- Extension 100%, max 35 kg (excl. recycling units).
- Extension 100%, max 65 kg.

## Shelves

All shelves are adjustable and mounted with milled-in shelf support. Drill division c/c 32 mm.

- 310 – 605 mm have a chip core.
- 800 – 900 mm have a pine lamellar core.

## Recycling unit

### MDL60/MD60/MDH60/MD65/MD70

The bottom plate is equipped with an access ramp in stainless steel.

- Doors with aximat hinges for 180 degree opening for easy access to recycling containers.

## Mail shelves

Adjustable with pull-out function and mounting strip, subdivision c/c 96 mm.

- Mail shelves in acrylic have integrated name slots.
- Mail shelves in powder coated steel white or black are available as an addition.

## Steel doors mail sorting

White powder coated steel. Shelves inside in the same material as frame, 19 mm.

- Including lock and 2 keys with individual lock number.
- Inlet 22 mm. Open door gives a free space of 90 mm.

## Wall modules

White lacquered mounting strip in steel is included for all wall modules.

## Lock types

Cabinets locks, padlock fittings, code locks and RFID-locks (EM & Mifare). For network-based locks contact TreCe for individual advice.

## Fitting pieces /Cover panels

Available as accessories in the same colour/material as frame. Width, height and depth adapted to your requirements.

## Handles

Stainless steel bow handles as standard, if you would like black or white handles, please not on order.

- Standard handles c/c 128 mm.
- Grip handles 40 mm.

## Work tops

**High pressure laminate:** 23 mm standard work-tops with high pressure laminate and 2 mm matching airtec-lipping.

- Formica Collection Colours
- Formica Collection Woods

**MFC laminate:** 22 mm standard worktops have an outer paper layer coated with an impregnated paper and a finish of Aluminium particles for extra protection against wear. 2 mm matching airtec-lipping.

**Veneer:** 22 mm clear lacquered beech, birch or oak veneered chipboard with 2 mm solid lipping.

**Airtech-lipping:** Airtec-lipping, also known as laser edging, provides an almost invisible joint between the worktop and edging strip. Thus provides a higher protection against water and heat. This new technology is glue-free, which results in a lower environmental impact.

**Inserts:** Powder-coated steel insert, available in white or black.

- Round with diameter 110, 250 or 400 mm.
- Square 250x250 mm or 350x350 mm.
- Slim 340x40 mm.

**Lid for insert:** Powder-coated steel. Available for round inserts with diameters 250 and 400 mm.

**Inserts:** Stainless steel, integrated ring in worktop

- Round 250 mm in diameter.

**Lid for insert:** Compact laminate, folded in / integrated into ring, thickness 6 mm

- Round 250 mm in diameter with knob.
- Compact laminate, Formica F2297 (anthracite) alt. F1040 (white).

## General info

### Mounting

All modules are factory mounted. Worktops/ Cover panels/Top covers are mounted on site.

### Warranty

We provide a 5 year factory warranty on CombiLine. Other products, contact TreCe.

### Cabinet locks

Robust cabinet locks with master key system, individual numbers with 2 keys as standard. Identical locks available to addition.

Contact TreCe for customization of selected product.

## QUICK INFO.

Content	Certification TreCe	Certification TreCe
Environmental, quality & social aspects	ISO 9001:2015	ISO 14001:2015
Tillverkningsland	Certification Product	Approved user environments
Sweden	Möbelfakta	Offices, public spaces & schools



## SVHC/ECHA's candidate list

No chemicals included in ECHA's candidate list of SVHC may be contained in levels of >0.1% by weight in the components, parts or chemicals that are included or used in the manufacturing of the furniture/product. See <http://echa.europa.eu/en/candidate-list-table>

## Wood

Routines must be in place to ensure that wood based materials are traceable and come from legal and acceptable sources, see table 1. Particleboards in white, beech, birch and oak meet the requirements.

**Table 1:** Requirements wood

Requirements	Complies
Has legal ownership and access rights	X
Follows nationally and locally applicable laws and regulations regarding use, environment, labour and welfare, health and safety, and other parties' rights.	X
Pays the relevant taxes and charges related to use.	X
Follows CITES regulations (only applicable to certain tree species, see the CITES website).	X
The wood complies with the requirements for formaldehyde emission requirements according to E1.	X

## Metal

Fittings such as hinges, screws and handles for-fill the requirements in table 2.

**Table 2:** Requirements metal

Requirements	Complies
Metal that will have prolonged contact with skin (e.g. armrests) must not consist of alloys containing nickel, chromium III or chromium VI.	X

## Adhesives

Adhesives used in manufacturing meet the requirements of table 3 which limit the use of environmentally and health hazardous volatile organic solvents (VOCs) and hazardous formaldehyde.

**Table 3:** Requirements adhesives

Requirements	Complies
Adhesives used in the manufacture of furniture or components for furniture may contain a maximum of 10% by weight VOC.	X
Adhesives used in the manufacture of furniture or components for furniture may contain a maximum of 0.2% by weight of free formaldehyde.	X

## Plastic

Plastic parts such as edgings, fittings and post shelves meet the requirements in table 4. For example, the post shelf is marked according to ISO 11469 with a stamp. The stamp shows the type of plastic and thus makes it possible to recycle and reuse the material.

**Table 4:** Requirements plastic

Requirements	Complies
Plastic parts >50 grams are permanently marked according to ISO 11469	X
Free from PVC (polyvinyl chloride)	X
Softeners/phthalates classified as hazard classification H360 have not been actively added or that the measured level does not exceed 0.1% by weight/substance and component.	X
Short-chain chlorinated paraffins (SCCPs) must not be actively added or that the measured level must not exceed 0.01% by weight/substance and component.	X
The following flame retardants have not been actively added or that the measured level does not exceed 0.1% by weight/substance and component.	X
Polybrominated biphenyls (PBBs)	CAS-nr: 59536-65-1
Decabromodiphenyl ether (dekaBDE)	CAS-nr: 1163-19-5
Pentabromodiphenylether (pentaBDE)	CAS-nr: 32534-81-9
Oktabromodiphenylether (oktaBDE)	CAS-nr: 32536-52-0
Tris (2,3-dibromopropyl) phosphate (TBPP)	CAS-nr: 126-72-7
Tris (1-aziridinyl) phosphine oxide (TEPA)	CAS-nr: 5455-55-1
Hexabromocyclododecane (HBCDD)	CAS-nr: 25637-99-4
Tris (2 chloroethyl) phosphate (TCEP)	CAS-nr: 115-96-8
No pigments containing lead, cadmium, tin, chromium VI or mercury have not been actively added or that the measured level does not exceed 0.01% by weight per component.	X

## Surface treatment – white

Doors and fronts are UV-lacquered in white and meet the requirements stated in Tables 5 and 6. Safety data sheets according to REACH CLP-regulation no1272/2008 are sent on request. Direct laminate products in beech, birch and oak are not surface treated.

**Table 5:** Requirements surface treatment

Requirements	Complies
The content of aromatic solvents / hydrocarbons in surface treatment products / preparations may not exceed 1.0% by weight.	X
Surface treatment with preparations containing VOC may have a maximum applied VOC component of 60 g / m <sup>2</sup> for office / public / outdoor environment.	X

**Table 6:** Hazard class and hazard statement according to Regulation 790/2009

Hazard category	Hazard statement according to regulation 790/2009	Complies
Acute toxicity	H300, H301, H310, H311, H330, H331	X
Toxic to body organs	H370, H371, H372, H373	X
Carcinogenic	H350, H351	X
Mutagenic	H340, H341	X
Toxic for reproduction	H360, H361	X
Allergenic	H334	X
Dangerous to the environment	H400, H410, H411, H412, H413 If the use of surface treatment products is required for technical reasons, products labelled as dangerous to the environment (H400, H410, H411, H412, H413) may be acceptable if the content of environmentally hazardous substance <14 g/per m <sup>2</sup> of surface.	X



## The production

CombiLine is manufactured and assembled in Sweden. Environmental aspects related to production are presented in table 7.

**Table 7:** The environmental aspects of production

Environmental aspect	
<b>Environmentally classified materials / chemicals</b>	Particularly hazardous chemicals, phasing out substances or priority risk reduction substances are not used. Handling and storage of all chemicals and substances are regulated so emissions to air, ground or water do not occur.
<b>Surface coating</b>	During the surface coating the production works actively to minimise the environmental impact through special handling and environmentally adapted colors and solvents. For example excess paint is collected and reused.
<b>Emissions air</b>	Emissions below the set license conditions. An air filter cleaner is installed that recycles tempered air which saves energy and reduces emissions to the outdoor environment.
<b>Emissions water</b>	Emissions below the set license conditions. Substances that are discharged into wastewater are environmentally friendly and contain no chemicals that the treatment plants cannot handle. Adhesives and varnishes that according to the safety data sheet are considered to pose a risk when released into water are collected in sealed containers and classified and treated as dangerous waste.
<b>Waste</b>	Residual material from particleboard is baled and collected for combustion in order to extract energy. TreCe is connected to the Packaging and Newspaper Collection (FTI). Waste is sorted according to the regulations that are based on the FTI and current legislation. Waste and residual products such as glue and oil residues are handled and collected separately.
<b>Energy</b>	In order to minimise energy consumption, heating is regulated based on working hours and which workstations are staffed. Investment in a compressor for a sustainable use of electricity resulted in an energy reduction of about 110,000 kWh/year.
<b>Production optimization</b>	The production process is optimised to save on materials, resulting in a reduced amount of waste, and to minimise energy consumption.
<b>Energy per product</b>	The energy consumption in electricity per product is 8.8 kWh.

## The product

Environmental aspects linked to the product in addition to the materials are presented in table 8.

**Table 8:** The products aspects

Aspect	
<b>Packaging</b>	Stretch film and corrugated board used to pack TreCe products are free of chlorine and bleach. The box is glued with wheat or cornstarch.
<b>Reuse and restoration</b>	One of our core values is Smart design. This means, among other things, that we look at design from a wider perspective. TreCe products are long lasting. Instead of replacing the whole piece of furniture, there is the option of replacing only a few parts. In this way, our products become sustainable in the long term — a benefit for both you as a user and for the environment.
<b>Lifetime and warranty</b>	TreCe provides a 5-year warranty on the entire range and spare parts are available for 10 years. The estimated usage life is from 5 years up to 30 years, depending on the area of use.
<b>Recycling</b>	Material recycling leads to a reduction in virgin material extraction and thus reduces carbon dioxide emissions. Hinges and fittings can be melted down and wood-based materials can be recycled for the production of new chipboard which is almost as high quality as virgin. The materials are submitted to recycling facilities, contact your municipality for more information. CombiLine is designed so that the different materials can be separated without special tools. When dismantling, no environmentally hazardous emissions occur.

## Social responsibility

We have ensured that this product is manufactured under good conditions, ie. with regard to social and ethical issues such as working conditions, human rights, labour, environment and corruption. We have sent these requirements to our suppliers and subcontractors, who have each certified that they are followed. A summary is shown in table 9 and applies to the entire manufacture process of a product and it's components. The starting point is the UN guidelines on the "Code of Conduct" and Möbelfakta's requirements for Social Responsibility are formulated on the basis of the UN's Global Compact. As well as conditions for social and ethical considerations regarding tax irregularities and illegal labour. The principles are based on below;

- UN Universal Declaration of Human Rights
- Rio Declaration on Environment and Development
- International Labour Organization (ILO) eight core conventions on human and labour rights
- UN Convention against Corruption
- Work environment requirements based on ILO conventions on health and safety

**Table 9:** Summary requirements for social responsibility

Requirements		Complies
<b>Legislation</b>	The furniture and its components must be manufactured in accordance with national legislation.	X
<b>Human Rights</b>	Producers, manufacturers and suppliers operations must comply with human rights.	X
<b>Working conditions</b>	Wages, child labour, conditions of employment, working hours, benefits, penalties, freedom of association, forced labour and discrimination.	X
<b>Working environment</b>	The company must constantly strive to improve the working environment and workplace safety for its employees.	X
<b>Environment</b>	Identify environmental impact, work actively with environmental issues and involve staff. Procedures for law compliance must be in place and followed up.	X
<b>Anti-corruption</b>	No form of extortion, corruption, bribery or favoritism to or from employees or organizations is tolerated.	X
<b>Tax irregularities /fraud</b>	In addition to the statutory obligations applicable to the employees concerned, shall also anti-labour and tax fraud are applied, such as illegal workers.	X
<b>Undeclared/illegal labour</b>	No undeclared/illegal labour shall be hired to preform product manufacturing.	X

## Quality

This product has undergone extensive quality tests for safety and function, as well as surface resistance. The criteria and standards apply to the public environment, school environment and office environment and are shown in tables 10 and 11. The tests were conducted by RISE, a Swedish government research institute that performs testing and certification.

**Table 10:** Approved user environments

Product	Approved user environments	Complies
<b>CombiLine-products with Möbelfakta label</b>	Public environment	X
	School environment	X
	Office environment	X

**Table 11:** Standards against which the product has been tested and approved

Standard	Scope	Complies
<b>SS-EN 14073-2:2004</b>	Office furniture — Storage furniture — Part 2: Safety requirements	X
<b>SS-EN 16121:2013 + A1:2018</b>	Non-domestic storage furniture — Requirements for safety, strength, durability and stability	X
<b>SS-EN 12720:2009 + A1:2013</b>	Surface resistance	X
<b>SS 839117</b>	Public environment / office	