

# Space personal storage

Design | TreCe



Flexible modules designed for both personal and general storage in offices and public environments. Space is easy to integrate thanks to its cohesive and thoughtful design. Well-crafted details such as doors in a seamless design, shoe shelves, and benches that complement with fronts create a seamless and stylish atmosphere. This is also reflected in the fact that Space is a sustainable choice, as it is approved according to Möbelfakta, made from sustainable materials, manufactured with social responsibility, and quality tested at RISE.

The modules in the Space series are created to fit together, allowing you to let your imagination flow freely when building your unique solution. Choose from various heights of frames and fronts. Frames in standard white or painted in any NCS color of your choice. Doors in painted MDF, any NCS color of your choice, oak, and ash laminate with a seamless design. Open frames such as clothing storage, benches, shoe shelves, etc., are available in painted NCS color of your choice as well as in oak and ash laminate. Explore the entire Space series, which includes personal and communal storage, wardrobes, seating modules, cabinets, recycling units, and more.

Space has a plinth as standard. For a different look, the plinth can be replaced with lacquered leg frames for an additional charge. The leg frames are available in our 11 standard colours.

## Locks and Closures

We offer various types of locks and closures for our doors, such as electronic RFID locks, code locks, cabinet locks, padlock fittings, and push open. For network-based locks, please contact TreCe for personalized advice.

## Accessories

For Space storage cabinets, accessories such as movable shelves, clothes rails, mirrors, hooks, mats, the cork box Stuff, and Office products are available.

## Customization

Space can be customized in both material and dimensions if you wish to put your own mark on the furniture. Contact TreCe for advice and a quote.

Reference images of both standard and customised Space





Reference images of both standard and customised Space



Space Combinations

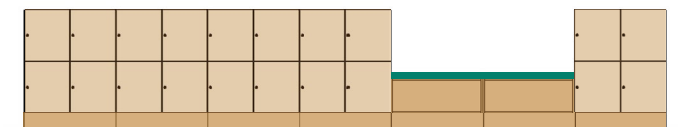
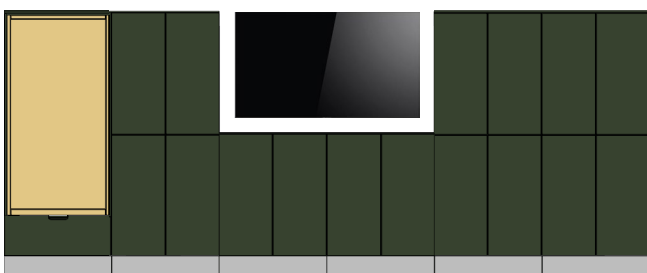
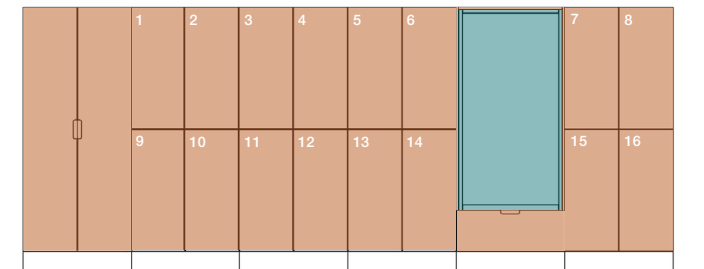
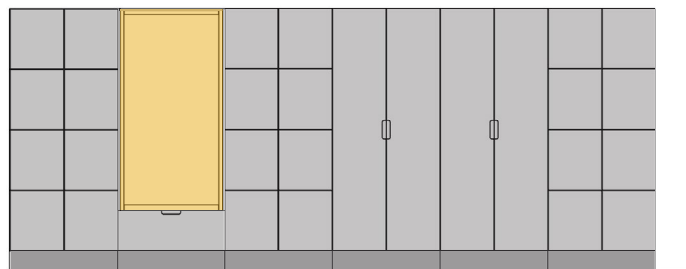
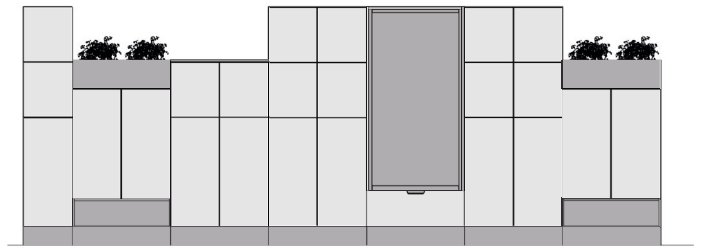
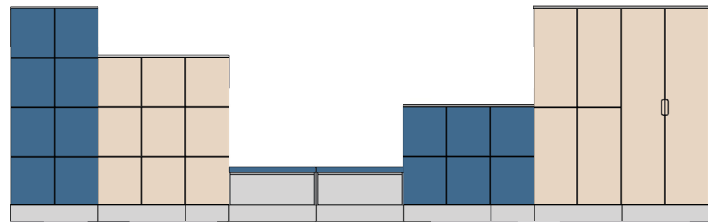
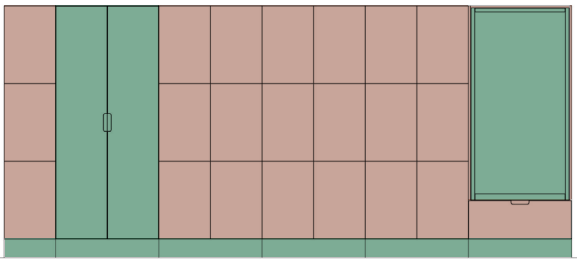
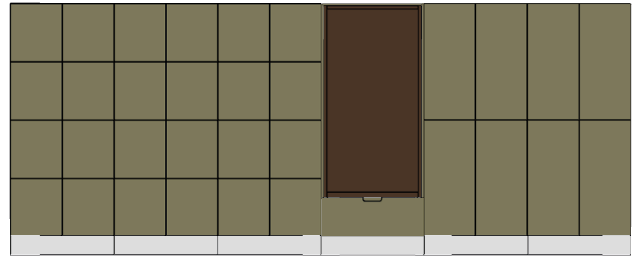
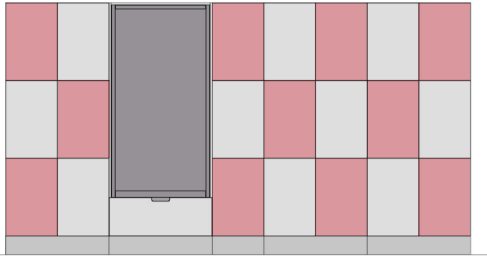

**Dimensions:** Width x Height (incl. plinth). x Depth. **Frame and front:** 16 mm. **Plinth:** 143 mm.  
All doors are right-hung as standard.

### Complete modules - including cabinet locks

**Cabinet locks:** included in ready-made modules, including 2 keys.

**Frames, plinths, backs, and dividers:** in white direct laminate, 16 mm with 0.8 mm straight ABS edge banding.

**Fronts:** 16 mm lacquered MDF, NCS S 0500-N, white.

**Plinth height:** 143 mm.

### Inside dimensions/door

**Space door H446:**

**Single** = B363 x H424 x D454 mm

**Double** = B371 x H424 x D454 mm

**Space door H894:**

**Single** = B363 x H864 x D454 mm

**Double** = B371 x H864 x D454 mm

**Space door H595:**

**Single** = B363 x H573 x D454 mm

**Double** = B371 x H573 x D454 mm

### Space complete modules - Hight 1039mm

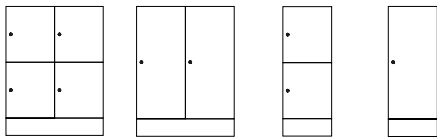

Space 1      Space 2      Space 7      Space 8

Name	Size	White
Space 1 double 1039, 4 door H446	790x1039x470	208111
Space 2 double 1039, 2 door H894	790x1039x470	208112
Space 7 single 1039, 2 door H446	395x1039x470	208117
Space 8 single 1039, 1 door H894	395x1039x470	208118

### Space complete modules - Hight 1487mm

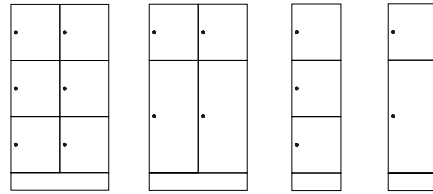

Space 3      Space 4      Space 9      Space 10

Name	Size	White
Space 3 double 1487, 6 door H446	790x1487x470	208113
Space 4 double 1487, 2 door H446 + 2 door H894	790x1487x470	208114
Space 9 single 1487, 3 door H446	395x1487x470	208119
Space 10 single 1487, 1 door H446+1 door H894	395x1487x470	208120

### Space complete modules - Hight 1936mm

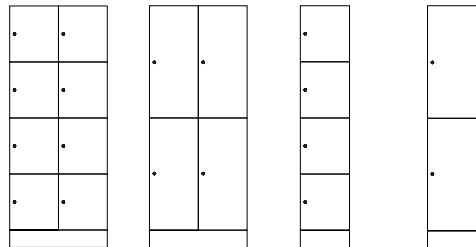

Space 5      Space 6      Space 11      Space 12

Name	Size	White
Space 5 double 1936, 8 door H446	790x1936x470	208115
Space 6 double 1936, 4 door H894	790x1936x470	208116
Space 11 single 1936, 4 door H446	395x1936x470	208121
Space 12 single 1936, 2 door H894	395x1936x470	208122

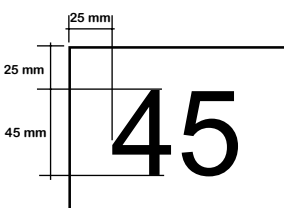

### Foiling numbers

3M high adhesive

Name	Colour	Art. no
Foiling numbers	Black	810077
Foiling numbers	White	810078
Foiling numbers, factory mounted		810009

Font: Arial Regular 188pt

For other fonts or colours, please contact TreCe.

### Space complete modules - Hight 1338mm

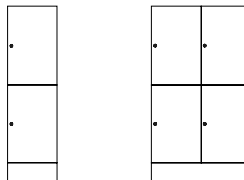

Space 15      Space 16

Name	Size	White
Space 15 single 1338, 2 door H595	395x1338x470	208125
Space 16 double 1338, 4 door H595	790x1338x470	208126

### Space complete modules - Hight 1936mm

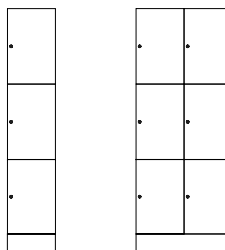

Space 13      Space 14

Name	Size	White
Space 13 single 1936, 3 door H595	395x1936x470	208123
Space 14 double 1936, 6 door H595	790x1936x470	208124

**Dimensions:** Width x Height (incl. plinth). x Depth. **Frame and front:** 16 mm. **Plinth:** 143 mm.  
All doors are right-hung as standard. .

**White:** Direct laminate. **NCS:** Lacquer, any NCS.  
Frames including plinth, excluding fixed and movable shelves. Double frames incl. dividers. Indicated number of doors, shows possible combinations.

### Space frame - Hight 592mm

Name	Size	White	NCS
Space single frame 592	395x592x470	201170	201171
Space double frame 592	790x592x470	201172	201173

### Space frame - Hight 1039mm

Name	Size	White	NCS
Space single frame 1039	395x1039x470	201108	201118
Space double frame 1039	790x1039x470	201111	201121

### Space frame - Hight 1487mm

Name	Size	White	NCS
Space single frame 1487	395x1487x470	201109	201119
Space double frame 1487	790x1487x470	201112	201122

### Space frame - Hight 1936mm

Name	Size	White	NCS
Space single frame 1936	395x1936x470	201110	201120
Space double frame 1936	790x1936x470	201113	201123

### Space frame - Hight 741mm

Name	Size	White	NCS
Space single frame 741	395x741x470	201174	201175
Space double frame 741	790x741x470	201176	201177

### Space frame - Hight 1338mm

Name	Size	White	NCS
Space single frame 1338	395x1338x470	201178	201179
Space double frame 1338	790x1338x470	201180	201181

### Space frame - Hight 1936mm

Name	Size	White	NCS
Space single frame 1936, door H595	395x1936x470	201124	201125
Space double frame 1936, door H595	790x1936x470	201126	201127

### Shelves

Name	Size	White	NCS
Space single shelf fixed, between compartments	363x16x 451	205009	205019
Space single shelf movable*	363x16x385	205010	205020
Space double shelf fixed, between compartments	371x16x451	205011	205021
Space double shelf movable*	371x16x385	205012	205022

\*Shortened in front

**Dimensions:** Width x Height (incl. plinth). x Depth. **Frame and front:** 16 mm. **Plinth:** 143 mm.

All doors are right-hung as standard.

NCS refers to product lacquered in one optional NCS colour.

## Doors and locks

**NCS:** Lacquered MDF, optional NCS

**Oak:** Oak laminate | **Ash:** Ash laminate

**Cabinet lock:** Includes 2 keys (see other locks on page 11)

\* RFID lock is optional, ordered separately. Contact TreCe.

\*\* Padlock not included.

Numbering on doors, see page 5

## Inside dimensions/door

**Space door H446:**

**Single** = B363 x H424 x D454 mm

**Double** = B371 x H424 x D454 mm

**Space door H894:**

**Single** = B363 x H864 x D454 mm

**Double** = B371 x H864 x D454 mm

**Space door H595:**

**Single** = B363 x H573 x D454 mm

**Double** = B371 x H573 x D454 mm



Mailbox powder coated, RAL 9016 white. Can be painted in any RAL colour, at an additional cost. Inlet: W:270 x H:125 mm.

## Doors

Name	Size	NCS	Oak	Ash
Space door 446, cabinet lock	393x446x16	202121	212121	222121
Space door 446, RFID exkl. lock*	393x446x16	202122	212122	222122
Space door 446, cabinet lock+post	393x446x16	202123	212223	222123
Space door 446, padlock fittings**	393x446x16	202124	212224	222124
Space door 446, RFID exkl. lock+post	393x446x16	202125	212225	222125
Space door 446, push open	393x446x16	202126	212226	222126

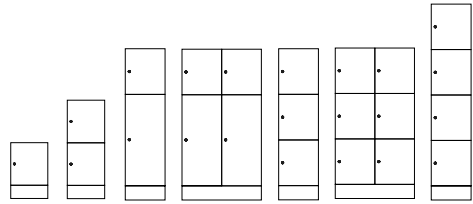

Space door 595, cabinet lock	393x595x16	202141	212141	222141
Space door 595, RFID exkl. lock*	393x595x16	202142	212142	222142
Space door 595, cabinet lock+post	393x595x16	202143	212143	222143
Space door 595, padlock fittings**	393x595x16	202144	212144	222144
Space door 595, RFID exkl. lock+post	393x595x16	202145	212145	222145
Space door 595, push open	393x595x16	202146	212146	222146

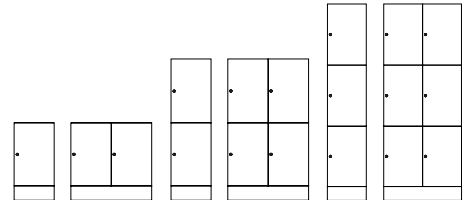

Space door 894, cabinet lock	393x894x16	203121	213121	223121
Space door 894, RFID exkl. lock*	393x894x16	203122	213122	223122
Space door 894, cabinet lock+post	393x894x16	203123	213123	223123
Space door 894, padlock fittings**	393x894x16	203124	213124	223124
Space door 894, RFID exkl. lock+post	393x894x16	203125	213125	223125
Space door 894, push open	393x894x16	203126	213126	223126
Space door 894, with inlet	392x894x16	203129	213129	223129

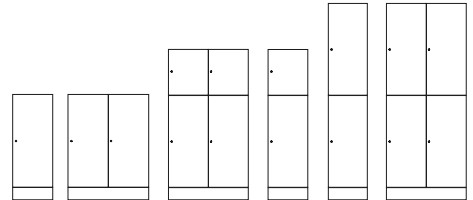

Space door 1342, cabinet lock	393x1342x16	204061	214061	224061
Space door 1342, RFID exkl. lock*	393x1342x16	204062	214062	224062
Space door 1342, cabinet lock+post	393x1342x16	204063	214063	224063
Space door 1342, padlock fittings**	393x1342x16	204064	214064	224064
Space door 1342, RFID exkl. lock+post	393x1342x16	204065	214065	224065
Space door 1342, push open	393x1342x16	204066	214066	224066

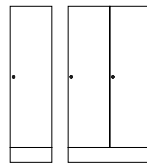

Space door 1790, cabinet lock	393x1790x16	204051	214051	224051
Space door 1790, RFID exkl. lock*	393x1790x16	204052	214052	224052
Space door 1790, padlock fittings**	393x1790x16	204054	214054	224054
Space door 1790, push open	393x1790x16	204056	214056	224056

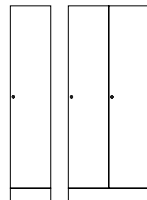

## Drawer

Name	Size	NCS	Oak	Ash
Space drawer 446, RFID* 100% pull-out, 35kg, high side railing	392x446x450	208060	218060	228060
Space drawer 446, RFID* 100% pull-out, 35 kg, low side railing	392x446x450	208061	218061	228061

If you want a different type of lock, contact TreCe.

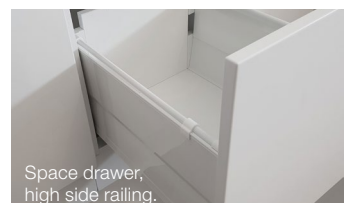

Space drawer,  
high side railing.



**Dimensions:** Width x Height (incl. plinth). x Depth. **Frame and front:** 16 mm. **Plinth:** 143 mm.

## Shoe shelf

Plinth not included.  
To be completed with plinth or leg stand.



Name	Size	NCS	Oak	Ash
Space single open shoe shelf 232	395x232x487	207092	217092	227092
Space double open shoe shelf 232	790x232x487	207091	217091	227091

**NCS:** Lacquered MDF, any NCS. | **Oak:** Oak laminate | **Ash:** Ash laminate  
Lives with fronts.

Accessories - Shoe shelf	Material	Size	Art.no
Space single carpet shoe shelf	Black rubber	363x475	209023
Space double carpet shoe shelf	Black rubber	758x475	209022

## Plinth

Name	Size	White	NCS	Oak	Ash
Space plinth, single	395x143x430	208072	208082	218072	228072
Space plinth, double	790x143x430	208071	208081	218071	228071
Space plinth, single back to back	395x143x450	208172	208182	218172	228172
Space plinth, double back to back	790x143x450	208171	208181	218171	228171

**White:** White direct laminate | **NCS:** Lacquered MDF, any NCS.  
**Oak:** Oak laminate | **Ash:** Ash laminate

## Storage box open/ Plant box



Name	Size	NCS	Oak	Ash
Space single open storage 232	395x232x487	209093	219093	229093
Space double open storage 232	790x232x487	209091	219091	229091
Space single open storage 232, back to back	395x232x976	209092	219092	229092

**White:** White direct laminate | **NCS:** Lacquered MDF, any NCS.  
**Oak:** Oak laminate | **Ash:** Ash laminate  
Lives with fronts.

Accessories - Storage box open/Plant box	Material	Size	Art.no
Space single carpet open storage	Black rubber	363x944	209025
Space double carpet open storage	Black rubber	773x455	209024
Plastic box 19 L, planting	Transparent	446x190x354	209099

## Leg stand

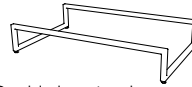

Double leg stand

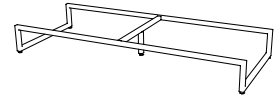

Triple leg stand

Name	Colour	Size	Art no.
Space double leg stand	RAL 9010	789x143x469	209101
Space double leg stand	RAL 7032	789x143x469	209102
Space double leg stand	RAL 7016	789x143x469	209103
Space double leg stand	RAL 5023	789x143x469	209104
Space double leg stand	RAL 1013	789x143x469	209105
Space double leg stand	RAL 6013	789x143x469	209106
Space double leg stand	RAL 6020	789x143x469	209107
Space double leg stand	RAL 8014	789x143x469	209108
Space double leg stand	RAL 1017	789x143x469	209109
Space double leg stand	RAL 3014	789x143x469	209110
Space double leg stand	RAL 3005	789x143x469	209111
Space triple leg stand	RAL 9010	1184x143x469	209121
Space triple leg stand	RAL 7032	1184x143x469	209122
Space triple leg stand	RAL 7016	1184x143x469	209123
Space triple leg stand	RAL 5023	1184x143x469	209124
Space triple leg stand	RAL 1013	1184x143x469	209125
Space triple leg stand	RAL 6013	1184x143x469	209126
Space triple leg stand	RAL 6020	1184x143x469	209127
Space triple leg stand	RAL 8014	1184x143x469	209128
Space triple leg stand	RAL 1017	1184x143x469	209129
Space triple leg stand	RAL 3014	1184x143x469	209130
Space triple leg stand	RAL 3005	1184x143x469	209131

**Space double leg stand:** Steel leg stand with adjustable feet, 4 legs. Fits Space double frame.  
Delivered not fitted to cabinet, leg stand must be adjusted in height before cabinet is lifted on.

**Space triple leg stand:** Steel leg stand with adjustable feet, 5 legs (1 support leg in the middle).  
Fits 1x Space double frame + 1x Space single frame. Delivered not fitted to cabinet, leg stand  
must be adjusted in height before cabinet is lifted on.

## Colours

RAL 9010 White	RAL 7032 Warm grey	RAL 7016 Anthracite	RAL 5023 Brilliant blue	RAL 1013 Pearl White	RAL 6013 Olive
RAL 6020 Forest green	RAL 8014 Chocolate	RAL 1017 Saffron	RAL 3014 Old Pink	RAL 3005 Wine red	



**Dimensions:** Width x Height (incl. plinth). x Depth. **Frame and front:** 16 mm. **Plinth:** 143 mm.  
All doors are right-hung as standard.

### Cover panels, thk 16mm

Name	Size	NCS	Oak	Ash
<i>When placed against a wall</i>				
Space cover panel single, 592	490x592	206033	216033	226033
Space cover panel single, 741	490x741	206037	216037	226037
Space cover panel single, 823	490x823	206035	216035	226035
Space cover panel single, 973	490x970	206039	216039	226039
Space cover panel single, 1039	490x1039	206021	216021	226021
Space cover panel single, 1271	490x1271	206041	216041	226041
Space cover panel single, 1339	490x1338	206031	216031	226031
Space cover panel single, 1487	490x1487	206022	216022	226022
Space cover panel single, 1936	490x1936	206023	216023	226023
<i>When placing modules back to back</i>				
Space cover panel double, 592	980x592	206034	216034	226034
Space cover panel double, 741	980x741	206038	216038	226038
Space cover panel double, 823	980x823	206036	216036	226036
Space cover panel double, 973	980x973	206040	216040	226040
Space cover panel double, 1039	980x1039	206521	216521	226521
Space cover panel double, 1271	980x1241	206042	216042	226042
Space cover panel double, 1338	980x1338	206032	216032	226032
Space cover panel double, 1487	980x1487	206522	216522	226522
Space cover panel double, 1936	980x1936	206523	216523	226523

**NCS:** Lacquered MDF, any NCS

**Oak:** Oak laminate | **Ash:** Ash laminate

### Top cover, thk 16mm

Name	Size	NCS	Oak	Ash
Space top cover panel single	490	207021	217021	227021
<i>When placing modules back to back</i>				
Space top cover panel double	980	207022	217022	227022

**NCS:** Lacquered MDF, any NCS.

**Oak:** Oak laminate | **Ash:** Ash laminate

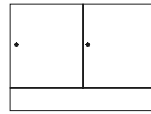

Space cover panel, 592

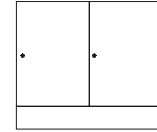

Space cover panel, 741

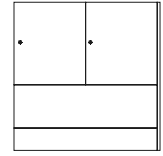

Space cover panel, 823

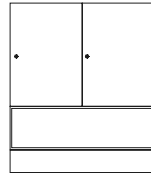

Space cover panel, 973

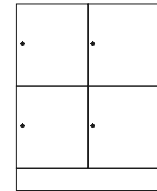

Space cover panel, 1039

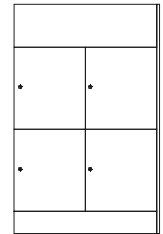

Space cover panel, 1271

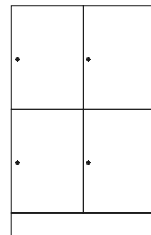

Space cover panel, 1338

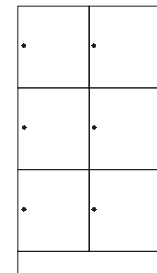

Space cover panel, 1487

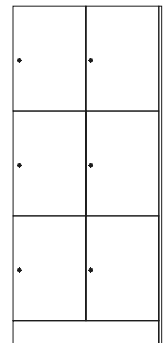

Space cover panel, 1936



**Dimensions:** Width x Height (incl. plinth). x Depth. **Frame and front:** 16 mm. **Plinth:** 143 mm.

All doors are right-hung as standard.

NCS refers to product lacquered in one optional NCS colour.

## Master key

Name	Art.no
Master key Cabinet lock	840913
Master key Code lock (mechanical)	890969
Master key Code lock (digital)	831099

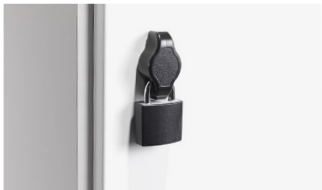

Padlock fittings, excluding padlocks.

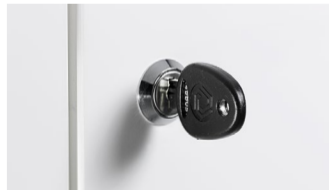

Cabinet lock, including 2 keys.



RFID lock, EM or Mifare.



Code lock, mechanical, for personal or public use.

## Accessories

Name	Material	Size	Art.no
Space shelf insert <i>Reversible shelf is mounted on the right or left side of the cabinet. Can also be painted in any RAL colour, at an additional cost.</i>	White metall	185x341x290	209040
Mirror		230x400	840912
Space single clothes rod	Aluminium	356	209009
Space double clothes rod	Aluminium	371	209010
Clothes hook, for clothes rail	Alu look		830006
Anchor hook, ceiling/shelf attachment	Alu look		830899
Stuff cork box	Cork	90x44x347	890101
Stuff shelf cork box	White aluminium	97x80x350	890201
Space single carpet	Black rubber	362x454	209026
Space double carpet	Black rubber	370x454	209027



Anchor hook



Clothes rod

## Alternative locks at extra cost

Name	Info
Code lock (mechanical)	For personal storage
Code lock (digital)	Available for both personal storage and public storage
RFID-lock	For personal/public storage



Digital code lock, black, for private or or public use.



Digital code lock, silver, for private or public use.

\*Contact TreCe for networked locks and locks as above.



Space shelf insert and rubber mat

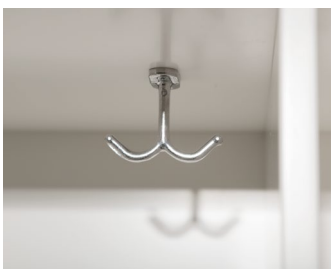

Anchor hook



Clothes rod

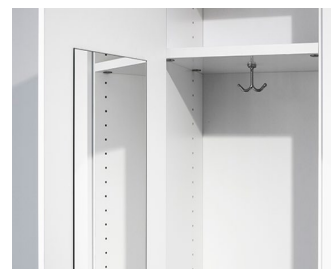

Mirror



The Stuff cork box and shelf keeps smaller items organised.

# Specifications Space

## Space

MFC laminated surfaces within Space have a chip core, with the exception of some shelves. Back, frame and edging strip have matching colours unless otherwise stated.

Lacquered fronts, Shoe shelf, Open shelf/Bench and Storage box open/Flower box have an MDF core. Textiles at an additional cost.

## Frame incl. plinth

Thickness 16 mm, 0.8 mm straight ABS-lipping.

- MFC laminate, white.
- Lacquered, any NCS-colour.
- Double module, width 790 mm
- Single module, width 395 mm

## Back

Thickness 16 mm, MFC laminate in- and out. Lacquered when choosing any NCS-colour.

## Plinth

Each unit has its own setback plinth, front and rear, with 4 adjustable feet, (Plinth height 143 mm.)

## Leg stand

Leg stand in steel with adjustable feet, 4 legs. Delivered not fitted to cabinet, leg stand must be adjusted in height before cabinet is lifted on.

- Leg stand double fits Space double.
- Leg stand triple fits 1x Space double + 1x Space single.
- Leg stand height 143 mm.
- Available in 11 RAL colours.

## Fronts

Seamless fronts, thickness 16 mm

- Lacquered MDF, any NCS colour, oak and ash laminate.

## Inside dimensions:

Space door low: W363 x H424 x D454 mm.

Space door middle: W363 x H573 x D454mm.

Space door high: W363 x H864 x D454 mm.

## Drawers

Drawers have soft closing. Extension capacity of 100 %, maximum weight 35 kg.

- Drawers with railings or with elevated sides.

## Doors to Space recycling units and Space counter

- With push open

## Seat module with hatch door

Opens downwards with gas spring.

- Milled-in handle. Are powder coated white as standard. Can be painted in any RAL colour at an additional cost.

## Cushions and fabric are additional

## Shoe shelf, Open shelf/Bench and Storage box open/Flower box

Thickness 16 mm.

- Lacquered MDF, any NCS colour, oak and ash laminate.
- Modules aligned with fronts.
- Plant pot can be combined with plastic box 19 L.
- Accessories: Seat cushion

## Double doors Wardrobes

With milled-in handles. Are as standard powder coated, white. It can be painted in any RAL colour at an additional cost.

## Mail inlet

Powder coated steel, White (RAL 9010).

Opening 290x20 mm. Mail inlet has an angled steel lip on the inside of the door.

## Hinges

- Self closing concealed hinges with integrated soft closing.
- Doors are right-hung as standard.

## Shelves, fixed

Shelves mounted with milled-in connection fittings that are secured with screws.

- Shelves lockers have a chip core
- Shelves for wardrobes have a lamellar wood core.

## Shelves, movable for personal storage

The shelf is recessed in the front edge.

Mounted with milled shelf brackets, movable according to drill division c/c 32 mm.

## Shelves, movable for storage

Installed with milled shelf brackets, movable according to drill division c/c 32 mm.

- 363 - 371 mm has chip core thickness of 16 mm
- 755 mm has laminated core with pine wood thickness 19 mm, max weight 120 kg.

## Cover panels/Top cover

Thickness 16 mm.

- Lacquered MDF, any NCS colour, oak and ash laminate.

## Top cover in compact laminate, black core

Thickness 12 mm.

- F2255, white
- F2297, anthracite
- F5343, olive grey

## Worktop in high pressure laminate

Thickness 23 mm

Formica Collection Colors

F2255, white | F2297, anthracite | F5343, olive

Pfleiderer Plain colours

R20095, Oak | R34027, Ash

## Inlets for top cover, compact laminate

- Inlets square B220 x D220 mm
- Inlet custom, max. size B220 x D260 mm

## Accessories

Space shelf insert, clothes rail, carpet, clothes hook, anchor hook, mirror and cork box Stuff.

## Cabinet locks

Robust cabinet locks with master key system, individual lock numbers and 2 keys as standard. Identical locks are available at extra cost.

## Lock types

Different types of locks and fittings are available for doors, such as electronic RFID locks, code locks, cabinet locks, padlock fittings and push-to-open. For network-based locks contact TreCe for individual advice.

## General care instructions

### Metal

Wipe with a slightly damp, soft lint-free cloth and mild detergent. Always wipe dry with a dry cloth. Never use solvents on painted metal nor any abrasive cleaners/ materials.

### Wood

Wood is a living material and is affected for example by seasons, heat and humidity. Direct sunlight will give surfaces permanent colour and light differences. To avoid colour shifts, all surfaces should be exposed to equal amounts of light.

### Normal/daily cleaning:

Dust dry and clean with mild soap solution or mild hand washing-up liquid. Wipe dry with a dry cloth. Never use strong detergents, solvents or products containing abrasives. Remove all stains as soon as possible and wipe the surface dry after cleaning.

**Note!** Use a minimum amount of water.

## General info

### Mounting

All modules are factory mounted. Worktops/ Cover panels/Top cover panels are mounted on site.

### Warranty

We provide a 5 year factory warranty on Space. Other products, contact TreCe.

Contact TreCe for customisation of selected product.

# Sustainability

## QUICK INFO.

Content	Certification TreCe	Certification TreCe
Environmental, quality & social aspects	ISO 9001:2015	ISO 14001:2015
Country of manufacture	Certification Product	Approved user environments
Sweden	Möbelfakta	Offices, public spaces & schools



## SVHC/ECHA's candidate list

No chemicals included in ECHA's candidate list of SVHC may be contained in levels of >0.1% by weight in the components, parts or chemicals that are included or used in the manufacturing of the furniture/product. See <http://echa.europa.eu/en/candidate-list-table>

## Wood

Routines must be in place to ensure that wood based materials are traceable and come from legal and acceptable sources, see table 1.

**Table 1:** Requirements wood

Requirements	Complies
Has legal ownership and access rights	X
Follows nationally and locally applicable laws and regulations regarding use, environment, labour and welfare, health and safety, and other parties' rights.	X
Pays the relevant taxes and charges related to use.	X
Follows CITES regulations (only applicable to certain tree species, see the CITES website).	X
The wood complies with the requirements for formaldehyde emission requirements according to E1.	X

## Metal

Fittings such as hinges, screws and handles for-fill the requirements in table 2.

**Table 2:** Requirements metal

Requirements	Complies
Metal that will have prolonged contact with skin (e.g. armrests) must not consist of alloys containing nickel, chromium III or chromium VI.	X

## Adhesives

Adhesives used in manufacturing meet the requirements of table 3 which limit the use of environmentally and health hazardous volatile organic solvents (VOCs) and hazardous formaldehyde.

**Table 3:** Requirements adhesives

Requirements	Complies
Adhesives used in the manufacture of furniture or components for furniture may contain a maximum of 10% by weight VOC.	X
Adhesives used in the manufacture of furniture or components for furniture may contain a maximum of 0.2% by weight of free formaldehyde.	X

# Sustainability

## Plastic

Plastic parts such as edgings, fittings and post shelves meet the requirements in table 4.

**Table 4:** Requirements plastic

Requirements	Complies
Free from PVC (polyvinyl chloride)	X
Softeners/phthalates classified as hazard classification H360 have not been actively added or that the measured level does not exceed 0.1% by weight/substance and component.	X
Short-chain chlorinated paraffins (SCCPs) must not be actively added or that the measured level must not exceed 0.01% by weight/substance and component.	X
The following flame retardants have not been actively added or that the measured level does not exceed 0.1% by weight/substance and component.	X
Polybrominated biphenyls (PBBs) CAS-nr: 59536-65-1	
Decabromodiphenyl ether (dekaBDE) CAS-nr: 1163-19-5	
Pentabromodiphenylether (pentaBDE) CAS-nr: 32534-81-9	
Oktabromodiphenylether (oktaBDE) CAS-nr: 32536-52-0	
Tris (2,3-dibromopropyl) phosphate (TBPP) CAS-nr: 126-72-7	
Tris (1-aziridinyl) phosphine oxide (TEPA) CAS-nr: 5455-55-1	
Hexabromocyclododecane (HBCDD) CAS-nr: 25637-99-4	
Tris (2 chlorethyl) phosphate (TCEP) CAS-nr: 115-96-8	
No pigments containing lead, cadmium, tin, chromium VI or mercury have not been actively added or that the measured level does not exceed 0.01% by weight per component.	X

## Surface treatment – white

Doors and fronts are UV-lacquered in white and meet the requirements stated in tables 5 and 6. Safety data sheets according to REACH CLP-regulation no1272/2008 are sent on request. Direct laminate products in beech, birch and oak are not surface treated.

**Table 5:** Requirements surface treatment

Requirements	Complies
The content of aromatic solvents / hydrocarbons in surface treatment products / preparations may not exceed 1.0% by weight.	X
Surface treatment with preparations containing VOC may have a maximum applied VOC component of 60 g / m <sup>2</sup> for office / public / outdoor environment.	X

**Table 6:** Hazard class and hazard statement according to Regulation 1272/2008

Hazard category	Hazard statement according to regulation 1272/2008	Complies
Acute toxicity	H300, H301, H310, H311, H330, H331	X
Toxic to body organs	H370, H371, H372, H373	X
Carcinogenic	H350, H351	X
Mutagenic	H340, H341	X
Toxic for reproduction	H360, H361, H362	X
Allergenic	H334	X
Dangerous to the environment	H400, H410, H411, H412, H413 If the use of surface treatment products is required for technical reasons, products labelled as dangerous to the environment (H400, H410, H411, H412, H413) may be acceptable if the content of environmentally hazardous substance <14 g/per m <sup>2</sup> of surface.	X
Hazardous to the ozone layer	H420	X

# Sustainability

## The production

Space is manufactured and assembled in Sweden. Environmental aspects related to production are presented in table 7.

**Table 7:** The environmental aspects of production

### Environmental aspect

<b>Environmentally classified materials / chemicals</b>	Particularly hazardous chemicals, phasing out substances or priority risk reduction substances are not used. Handling and storage of all chemicals and substances are regulated so emissions to air, ground or water do not occur.
<b>Surface coating</b>	During the surface coating the production works actively to minimise the environmental impact through special handling and environmentally adapted colors and solvents. For example excess paint is collected and reused.
<b>Emissions air</b>	Emissions below the set license conditions. An air filter cleaner is installed that recycles tempered air which saves energy and reduces emissions to the outdoor environment.
<b>Emissions water</b>	Emissions below the set license conditions. Substances that are discharged into wastewater are environmentally friendly and contain no chemicals that the treatment plants cannot handle. Adhesives and varnishes that according to the safety data sheet are considered to pose a risk when released into water are collected in sealed containers and classified and treated as dangerous waste.
<b>Waste</b>	Residual material from particleboard is baled and collected for combustion in order to extract energy. TreCe is connected to the Packaging and Newspaper Collection (FTI). Waste is sorted according to the regulations that are based on the FTI and current legislation. Waste and residual products such as glue and oil residues are handled and collected separately.
<b>Energy</b>	In order to minimise energy consumption, heating is regulated based on working hours and which workstations are staffed. Investment in a compressor for a sustainable use of electricity resulted in an energy reduction of about 110,000 kWh/year.
<b>Production optimization</b>	The production process is optimised to save on materials, resulting in a reduced amount of waste, and to minimise energy consumption.
<b>Energy per product</b>	The energy consumption in electricity per product is 8.8 kWh.

## The product

Environmental aspects linked to the product in addition to the materials are presented in table 8.

**Table 8:** The products aspects

Aspect	
<b>Packaging</b>	Stretch film and corrugated board used to pack TreCe products are free of chlorine and bleach. The box is glued with wheat or cornstarch.
<b>Reuse and restoration</b>	One of our core values is Smart design. This means, among other things, that we look at design from a wider perspective. TreCe products are long lasting. Instead of replacing the whole piece of furniture, there is the option of replacing only a few parts. In this way, our products become sustainable in the long term — a benefit for both you as a user and for the environment.
<b>Lifetime and warranty</b>	TreCe provides a 5-year warranty on the entire range and spare parts are available for 10 years. The estimated usage life is from 5 years up to 30 years, depending on the area of use.
<b>Recycling</b>	Material recycling leads to a reduction in virgin material extraction and thus reduces carbon dioxide emissions. Hinges and fittings can be melted down and wood-based materials can be recycled for the production of new chipboard which is almost as high quality as virgin. The materials are submitted to recycling facilities, contact your municipality for more information. CombiLine is designed so that the different materials can be separated without special tools. When dismantling, no environmentally hazardous emissions occur.

# Sustainability

## Social responsibility

We have ensured that this product is manufactured under good conditions, ie. with regard to social and ethical issues such as working conditions, human rights, labour, environment and corruption. We have sent these requirements to our suppliers and subcontractors, who have each certified that they are followed. A summary is shown in table 9 and applies to the entire manufacture process of a product and it's components. The starting point is the UN guidelines on the "Code of Conduct" and Möbelfakta's requirements for Social Responsibility are formulated on the basis of the UN's Global Compact. As well as conditions for social and ethical considerations regarding tax irregularities and illegal labour. The principles are based on below;

- UN Universal Declaration of Human Rights
- Rio Declaration on Environment and Development
- International Labour Organization (ILO) eight core conventions on human and labour rights
- UN Convention against Corruption
- Work environment requirements based on ILO conventions on health and safety

**Table 9:** Summary requirements for social responsibility

Requirements		Complies
<b>Legislation</b>	The furniture and its components must be manufactured in accordance with national legislation.	X
<b>Human Rights</b>	Producers, manufacturers and suppliers operations must comply with human rights.	X
<b>Working conditions</b>	Wages, child labour, conditions of employment, working hours, benefits, penalties, freedom of association, forced labour and discrimination.	X
<b>Working environment</b>	The company must constantly strive to improve the working environment and workplace safety for its employees.	X
<b>Environment</b>	Identify environmental impact, work actively with environmental issues and involve staff. Procedures for law compliance must be in place and followed up.	X
<b>Anti-corruption</b>	No form of extortion, corruption, bribery or favoritism to or from employees or organizations is tolerated.	X
<b>Tax irregularities /fraud</b>	In addition to the statutory obligations applicable to the employees concerned, shall also anti-labour and tax fraud are applied, such as illegal workers.	X
<b>Undeclared/illegal labour</b>	No undeclared/illegal labour shall be hired to preform product manufacturing.	X

## Quality

This product has undergone extensive quality tests for safety and function, as well as surface resistance. The criteria and standards apply to the public environment, school environment and office environment and are shown in tables 10 and 11. The tests were conducted by RISE, a Swedish government research institute that performs testing and certification.

**Table 10:** Approved user environments

Product	Approved user environments	Complies
<b>Space-products with Möbelfakta label</b>	Public environment	X
	School environment	X
	Office environment	X

**Table 11:** Standards against which the product has been tested and approved

Standard	Scope	Complies
<b>SS-EN 14073-2:2004</b>	Office furniture — Storage furniture — Part 2: Safety requirements	X
<b>SS-EN 16121:2013 + A1:2018</b>	Non-domestic storage furniture — Requirements for safety, strength, durability and stability	X
<b>SS-EN 12720:2009 + A1:2013</b>	Surface resistance	X
<b>SS 839117</b>	Public environment / office	